

CARBON STEEL \  
 CARBON STEEL

DRAWN BY: EF  
 DATE: 9/21/95 CK'D BY: FM  
 REV DATE: 10/11/95 CK'D BY: DT

DOUBLE CONTAINED  
 PIPING SYSTEMS

D10808TE

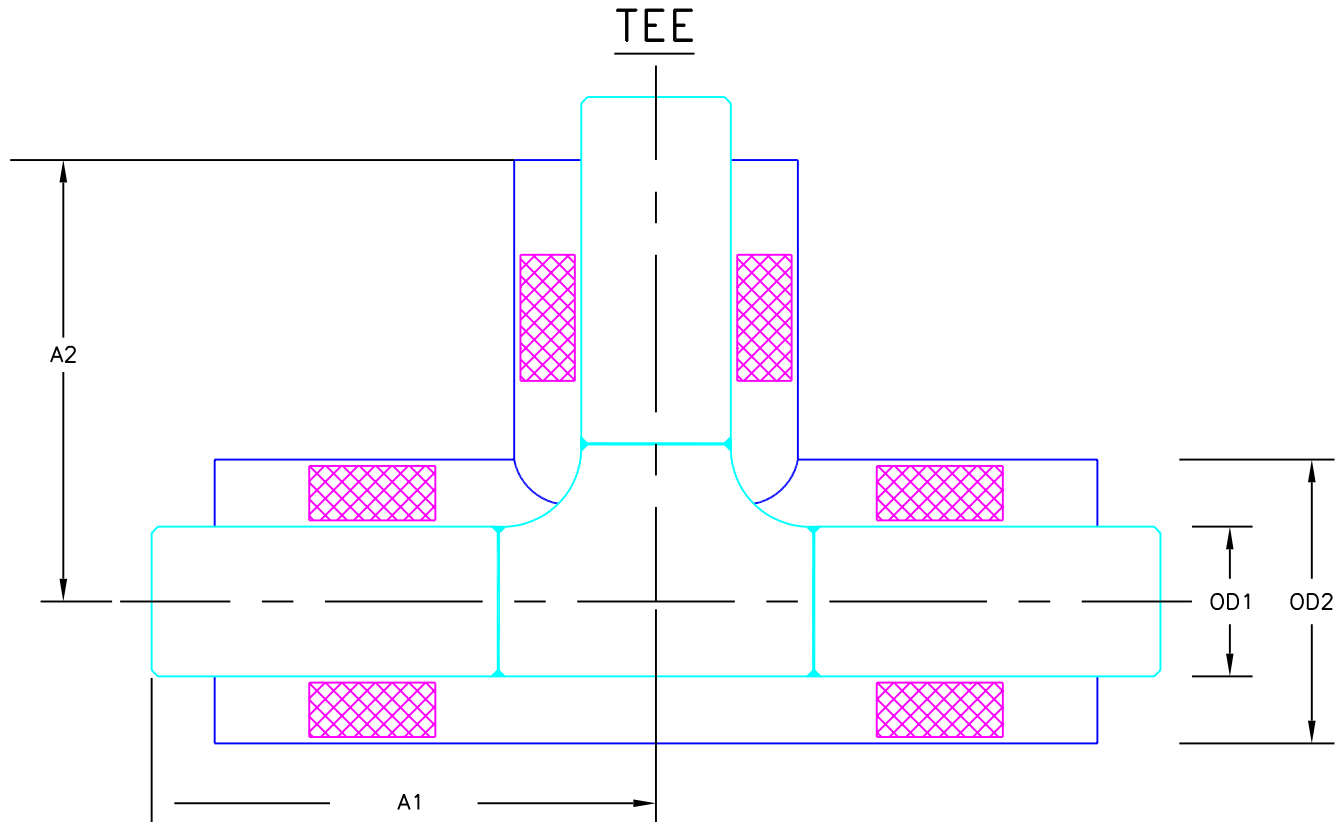

**DIMENSIONS**

CARRIER/ CONTAINMENT	A1	A2	OD1	OD2
1/2 X 2	4.50	3.50	.84	2.38
3/4 X 3	7.00	6.00	1.05	3.50
1 X 3	6.70	5.70	1.32	3.50
1 1/4 X 4	7.75	6.75	1.66	4.50
1 1/2 X 4	7.75	6.75	1.90	4.50
2 X 4	7.30	6.30	2.37	4.50
3 X 6	9.63	8.63	3.50	6.63
4 X 8	13.13	12.13	4.50	8.63
6 X 10	17.63	16.63	6.63	10.75
8 X 12	19.00	18.00	8.63	12.75

**GENERAL NOTES:**

CARRIER - 1/2 X 2 THROUGH 8 X 12 USE WELD TEE  
 ALL ENDS ARE BEVEL FOR WELD

CONTAINMENT - 1/2 X 2 THROUGH 8 X 12 USE MITERED PIPE  
 ALL ENDS ARE PLAIN END

ALL FITTINGS ARE FACTORY TESTED

ALL DIMENSIONS ARE IN INCHES UNLESS OTHERWISE INDICATED

ABOVE FITTING MEETS ASTM SPECIFICATIONS:  
 CARBON STEEL PIPE - A53B & A106  
 SCHEDULE 10\20\40\80  
 CARBON STEEL FITTING - A234

NOTE: