



# Z-1467 FLANGED ACCESS BOX

SPECIFICATION SHEET

TAG \_\_\_\_\_

Dimensional Data (inches and [ mm ]) are Subject to Manufacturing Tolerances and Change Without Notice

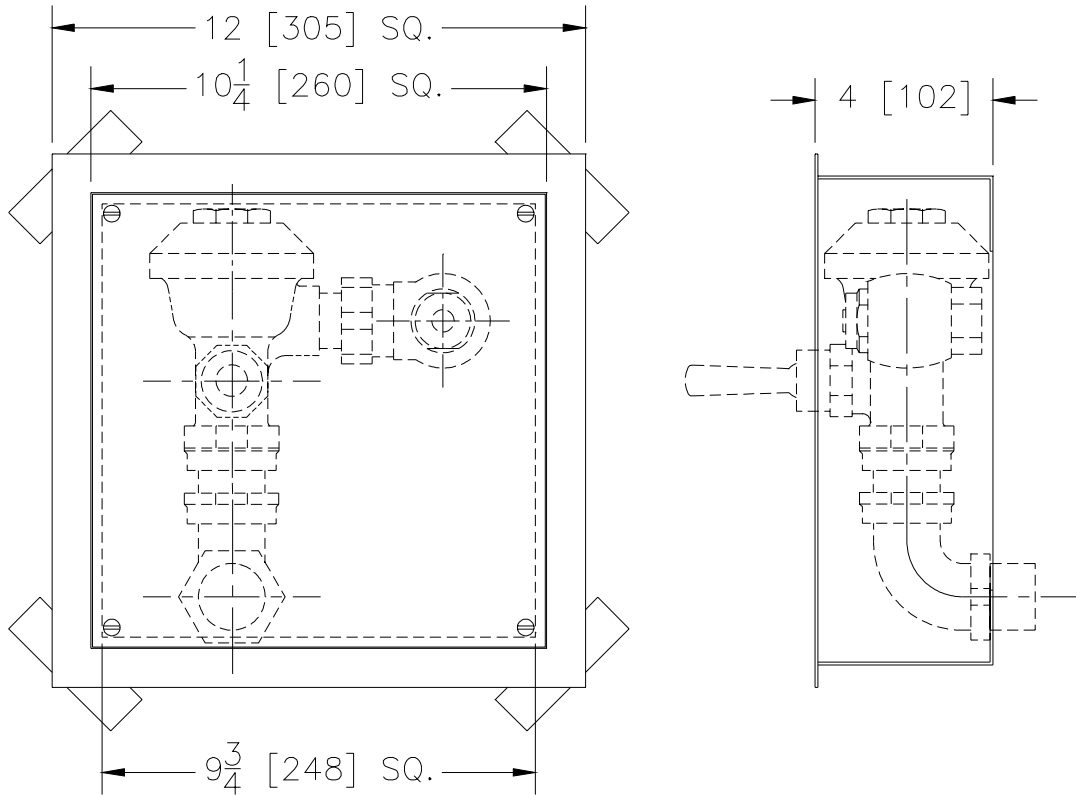

A-Opening Size Inches	Approx. Wt. Lbs. [kg]
9 3/4 x 9 3/4 [248 x 248]	20 [9]

**ENGINEERING SPECIFICATION:** ZURN ZS-1467 Square flanged wall access box for concealed flush valve. Smooth, stainless steel panel secured to flush over-wall frame.

**OPTIONS** (Check/specify appropriate options)

OPENING	DEPTH
9 3/4 Sq. [248]	4 [102]

**PREFIXES**

\_\_\_ ZS- Type 304 Stainless Steel\*

**SUFFIXES**

- \_\_\_ -HH Handle Hole (Specify Size and Location)
- \_\_\_ -VP Vandal Proof Secured Top

\*REGULARLY FURNISHED UNLESS OTHERWISE SPECIFIED

REV. C	DATE: 6/4/99	C.N. NO. 82617
DWG. NO. 58780	PRODUCT NO. Z-1467	