

Manual Valves

Price List Effective April 16, 2001



Silicone-Free Manual Valves

GEORGE FISCHER +GF+

Not for Use with Compressed Air or Gases

Warning:

Thermoplastic valves should not be tested or used with compressed air or gases.

This practice could result in explosive fragmentation of piping system and components (valves) causing serious or fatal bodily injury.

Only hydrostatic test methods should be used.

George Fischer, Inc. DOES NOT RECOMMEND the use of thermoplastic piping products for systems to transport or store compressed air or gases, or the testing of thermoplastic piping systems with compressed air or gases in above or below ground locations. The use of George Fischer, Inc. products in compressed air or gas systems automatically voids George Fischer, Inc. warranty for such products, and their use against our recommendation is entirely the responsibility and liability of the installer. George Fischer, Inc. will not accept responsibility for damage or impairment from its products, or other consequential or incidental damages caused by misapplication, incorrect assembly, and/or exposure to harmful substances or conditions.



Ball Valve Type 546, PVC SF solvent cement sockets, Inch ASTM

Features:

- Paint-compatible / silicone-free
- Ball seals in PTFE
- True union ball valve for easy installation and removal
(z-dimension, valve end and valve nut **are not compatible** with Type 346)
- Integrated stainless steel mounting inserts

Options:

- Individual configuration of the valve (see price sheets)
- Multifunction module with integrated limit switches

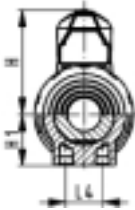
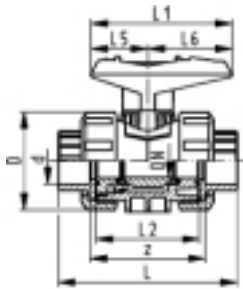

inch	DN	psi	Cv value ($\Delta p = 1 \text{ psi}$)	EPDM Seals	\$	FPM Seals	\$
3/8	10	232	4.97	161 546 841	42.00	161 546 851	50.00
1/2	15	232	12.95	161 546 842	43.00	161 546 852	52.00
3/4	20	232	24.50	161 546 843	50.00	161 546 853	60.00
1	25	232	49.01	161 546 844	61.00	161 546 854	76.00
1 1/4	32	232	70.02	161 546 845	79.00	161 546 855	93.00
1 1/2	40	232	112.04	161 546 846	100.00	161 546 856	119.00
2	50	232	217.08	161 546 847	126.00	161 546 857	158.00

inch	DN	D	H	H1	L	L1	L2	L4	L5	L6	z	lbs		
3/8	10	1.97	2.24	1.04	4.13	3.03	2.20	0.98	1.26	1.77	2.64	0.34		
1/2	15	1.97	2.24	1.04	4.13	3.03	2.20	0.98	1.26	1.77	2.40	0.34		
3/4	20	2.28	2.64	1.18	4.76	3.82	2.56	0.98	1.54	2.28	2.76	0.53		
1	25	2.68	2.87	1.40	5.24	3.82	2.80	0.98	1.54	2.28	2.99	0.75		
1 1/4	32	3.31	3.54	1.73	6.06	5.04	3.35	1.77	2.13	2.91	3.54	1.33		
1 1/2	40	3.82	3.82	1.99	6.46	5.04	3.50	1.77	2.13	2.91	3.70	1.77		
2	50	4.88	4.57	2.52	7.20	5.98	3.98	1.77	2.58	3.41	4.21	3.21		



Ball Valve Type 546, CPVC SF with solvent cement sockets, Inch ASTM

Features:

- Paint-compatible / silicone-free
- True union ball valve for easy installation and removal (z-dimension, valve end and valve nut **are not compatible** with Type 346)
- Ball seals PTFE
- Integrated with stainless steel mounting inserts

Options:

- Individual configuration of the valve (see price sheets)
- Multifunction module with integrated limit switches

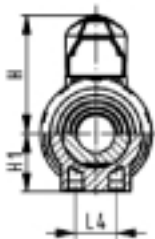
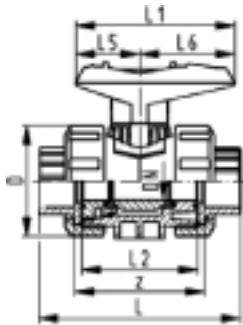

inch	DN	psi	Cv value ($\Delta p = 1 \text{ psi}$)	FPM Seals	\$	
1/2	15	232	12.95	163 546 852	82.00	
3/4	20	232	24.50	163 546 853	92.00	
1	25	232	49.01	163 546 854	113.00	
1 1/4	32	232	70.02	163 546 855	150.00	
1 1/2	40	232	112.04	163 546 856	176.00	
2	50	232	217.08	163 546 857	233.00	

inch	DN	D	H	H1	L	L1	L2	L4	L5	L6	z	lbs	
1/2	15	1.97	2.24	1.04	4.13	3.03	2.20	0.98	1.26	1.77	2.40	0.35	
3/4	20	2.28	2.64	1.18	4.76	3.82	2.56	0.98	1.54	2.28	2.76	0.54	
1	25	2.68	2.87	1.40	5.24	3.82	2.80	0.98	1.54	2.28	2.99	0.80	
1 1/4	32	3.31	3.54	1.73	6.06	5.04	3.35	1.77	2.13	2.91	3.54	1.45	
1 1/2	40	3.82	3.82	1.99	6.46	5.04	3.50	1.77	2.13	2.91	3.70	1.96	
2	50	4.88	4.57	2.52	7.20	5.98	3.98	1.77	2.58	3.41	4.21	3.63	

Silicone-Free Valves for Paint and Coating Applications

Type 360 Silicone-Free PVC True Union Ball Check Valve (A)

(Lead time - 1 day)



Inch Size	Socket/**Spigot EPDM Seals	\$	Threaded NPT EPDM Seals	\$	SP
3/8	161.360.641	44.20	161.360.661	47.50	1
1/2	161.360.642	46.00	161.360.662	49.30	1
3/4	161.360.643	54.70	161.360.663	61.50	1
1	161.360.644	66.50	161.360.664	73.80	1
1-1/4	161.360.645	112.00	161.360.665	131.00	1
1-1/2	161.360.646	126.00	161.360.666	135.00	1
2	161.360.647	135.00	161.360.667	151.00	1
3**	700.243.600	339.00	—	—	1

(3" is not true union)

(Lead time - 20 days)

Inch Size	Socket/**Spigot *FPM Seals	\$	Threaded NPT *FPM Seals	\$	SP
3/8	161.360.651	54.70	161.360.671	64.70	1
1/2	161.360.652	56.30	161.360.672	66.50	1
3/4	161.360.653	63.70	161.360.673	73.10	1
1	161.360.654	77.50	161.360.674	90.20	1
1-1/4	161.360.655	148.00	161.360.675	171.00	1
1-1/2	161.360.656	164.00	161.360.676	179.00	1
2	161.360.657	208.00	161.360.677	223.00	1
3**	consult factory	—	—	—	1

(3" is not true union)

Type 360 Silicone-Free CPVC True Union Ball Check Valve (A)

(Lead time - 1 day)



Inch Size	Socket EPDM Seals	\$	Threaded EPDM Seals	\$	SP
3/8	163.360.641	44.20	163.360.661	47.50	1
1/2	163.360.642	46.00	163.360.662	49.30	1
3/4	163.360.643	54.70	163.360.663	61.50	1
1	163.360.644	66.50	163.360.664	73.80	1
1-1/4	163.360.645	112.00	163.360.665	131.00	1
1-1/2	163.360.646	126.00	163.360.666	135.00	1
2	163.360.647	135.00	163.360.667	151.00	1

(Lead time - 20 days)

Inch Size	Socket *FPM Seals	\$	Threaded *FPM Seals	\$	SP
3/8	163.360.651	54.70	163.360.671	64.70	1
1/2	163.360.652	56.30	163.360.672	66.50	1
3/4	163.360.653	63.70	163.360.673	73.10	1
1	163.360.654	77.50	163.360.674	90.20	1
1-1/4	163.360.655	148.00	163.360.675	171.00	1
1-1/2	163.360.656	164.00	163.360.676	178.00	1
2	163.360.657	208.00	163.360.677	223.00	1

*FPM seals are made of Viton® or equal materials.

Viton® is a registered trademark of DuPont Dow Elastomers.

All lead times quoted are based on quantities ordered.

Orders must be placed in multiples of standard packaging (SP).

NOT FOR USE WITH COMPRESSED AIR OR GASES.

Silicone-Free Valves for Paint and Coating Applications

Type 314 Silicone-Free PVC Diaphragm Valve (A)

(Lead time - 28 days)



Inch Size	Socket EPDM Diaphragm	\$	Socket PTFE/EPDM Diaphragm	\$	SP		
1/2	161.314.777	102.00	161.314.792	170.00	1		
3/4	161.314.778	114.00	161.314.793	177.00	1		
1	161.314.779	146.00	161.314.794	263.00	1		
1-1/4	161.314.780	224.00	161.314.795	355.00	1		
1-1/2	161.314.781	226.00	161.314.796	355.00	1		
2	161.314.782	264.00	161.314.797	433.00	1		

Type 317 Silicone-Free PVC Diaphragm Valve (A)

(Lead time - 28 days)



4" size pictured

Inch Size	Flanged EPDM Diaphragm	\$	Flanged PTFE/EPDM Diaphragm	\$	SP		
1/2	161.317.747	178.00	161.317.762	247.00	1		
3/4	161.317.748	203.00	161.317.763	271.00	1		
1	161.317.749	231.00	161.317.764	353.00	1		
1-1/4	161.317.750	311.00	161.317.765	446.00	1		
1-1/2	161.317.751	313.00	161.317.766	451.00	1		
2	161.317.752	374.00	161.317.767	555.00	1		
2-1/2	161.317.753	533.00	161.317.768	836.00	1		
3	161.317.424	717.00	161.317.439	1118.00	1		
4	161.317.455	996.00	161.317.470	1567.00	1		
6	161.317.427	1961.00	161.317.442	3916.00	1		

Type 315 Silicone-Free CPVC Diaphragm Valve (A)

(Lead time - 28 days)



Inch Size	Spigot EPDM Diaphragm	\$	Spigot PTFE/EPDM Diaphragm	\$	SP		
1/2	163.315.817	165.00	163.315.832	232.00	1		
3/4	163.315.818	178.00	163.315.833	253.00	1		
1	163.315.819	230.00	163.315.834	316.00	1		
1-1/4	163.315.820	297.00	163.315.835	391.00	1		
1-1/2	163.315.821	336.00	163.315.836	442.00	1		
2	163.315.822	353.00	163.315.837	495.00	1		

Type 306 Silicone-Free PVC Line Strainer (A)

(Lead time - 28 days)

with 20 mesh screens



Inch Size	Spigot EPDM Seals	\$	Spigot *FPM Seals	\$	SP		
1/2	192.306.951	53.20	192.306.961	64.70	1		
3/4	192.306.952	62.00	192.306.962	71.60	1		
1	192.306.953	67.60	192.306.963	77.50	1		
1-1/4	192.306.954	119.00	192.306.964	132.00	1		
1-1/2	192.306.955	119.00	192.306.965	142.00	1		
2	192.306.956	147.00	192.306.966	176.00	1		
3	192.306.958	297.00	192.306.968	349.00	1		

*FPM seals are made of Viton® or equal materials.

Viton® is a registered trademark of DuPont Dow Elastomers.

All lead times quoted are based on quantities ordered.

Orders must be placed in multiples of standard packaging (SP).

NOT FOR USE WITH COMPRESSED AIR OR GASES.

General Terms and Conditions of Sale

These Terms and Conditions (Rev. 6/2003) supercede all previous Terms and Conditions.

It is the responsibility of the Distributor, Dealer, Agent to provide a current copy of these Terms and Conditions to the Consumers of George Fischer products.

• Acceptance of Terms and Conditions

Acceptance by Customer of George Fischer, Inc.'s (hereinafter "Seller" or "GFI") offer of Products for sale is hereby expressly conditioned upon Customer's acceptance of these General Terms and Conditions of Sale and these General Terms and Conditions of Sale will be deemed accepted, as written, despite any language in Customer's purchase order and/or other documentation which is either conflicting or supplemental, unless promptly after receipt of this offer, Customer specifically advises Seller of each term and condition not so accepted and Seller accepts Customer's conflicting and/or supplemental term(s) in writing.

• Order Acceptance

Seller reserves the right to accept or reject any order. Possession of a price list by Customer does not constitute an offer to sell.

• Credit Approval/Minimum Order Charge

Customer credit approval is required prior to any shipments. The minimum order charge is \$100.00 net.

• List Price, Discount or Freight Charges

List prices, discount, and freight terms are subject to change without notice. All prices are F.O.B., Seller's factory or authorized warehouse at Seller's discretion. Products listed hereon will be invoiced at price prevailing at time of shipment.

• Standard Terms

Net 30, 2% 15 days from date the invoice is issued from GFI. **No unauthorized deductions allowed, such as deductions for pending Returned Materials Transactions that are subject to review.** GFI reserves the right to apply a finance charge to the balance of any past-due invoice (over 30 days from date of invoice) at a rate of 1.5% per month, 18% per annum. Invoices past due forty-five (45) days will be subject to review and account status may be put on hold.

• Mode of Shipment or Packaging

Seller reserves the right to ship orders in the most economical manner. However, where Customer requests special packaging or handling, any additional cost will be the responsibility of the Customer.

• Taxes

Any and all sales taxes, Manufacturer's taxes and/or other charges levied or imposed by any governmental authority, foreign or domestic, upon any merchandise sold or contracted to be sold shall be paid by Customer and added to the purchase price unless satisfactory and appropriate tax exemption certificates are supplied to the Seller.

• Cancellations or Add-ons

Cancellation or modifications of orders must be consented to by Manufacturer in writing. Since all orders are individually entered for processing immediately upon receipt, Seller reserves the right to charge back to the Customer costs incurred from either cancellation of the order, change of the order or of any item on the order. Seller also reserves the right to consider all order add-ons as new orders and subject to all terms and conditions. Products can only be added to orders the same day the order was entered. Distributors may cancel stock items that are **NOT** non-cancelable or non-returnable up to the day it ships.

• Product Changes

Seller reserves the right to alter, modify or redesign its products without any obligation to replace Products previously shipped.

• Delivery

Customer is advised that quoted delivery dates or schedules are based on estimates at the time of quotation and that Seller will devote its best efforts to meet such schedules. However, Seller assumes no liability for additional cost or damages resulting from late deliveries.

• Freight Terms

In the continental USA and Canada: Full freight will be paid on pipe, valve, and fitting orders \$1,500 net or more, except PVDF pipe in which full freight will be paid on orders of \$4,000 net or more. Freight allowed orders will be sent by a designated carrier of Seller's choice. Additional charges will be made for special handling and air freight when requested.

All Signet products are shipped F.O.B. factory. Unless otherwise specified, shipments are UPS surface; prepaid and added to the invoice.

• Transfer of Ownership

Title to merchandise passes at point of shipment. Claims for damaged merchandise should be made to carrier.

• Damage, Loss or Shortage Claims

Common carrier or motor freight shipment must be inspected for damage, loss or shortage upon receipt by consignee prior to acceptance from carrier.

Any damage or loss claims must be made to the carrier. Seller will not be liable in any manner for damage or loss caused to a shipment by a common carrier.

Shortage of material claims regardless of "mode of shipment" must be submitted in writing to Seller within fifteen (15) days of invoice date. In the event of such claims, Customer shall be required to make timely payment to Seller of any amount which is undisputed or not subject to such claims.

• Returned Materials – Restock and Evaluations

The standard restocking charge is 25%. Products denoted with a caret (^) symbol have a 40% restocking charge and products with an asterisk (*) symbol are non-cancelable/non-returnable. Only items identified on the current Master Distributor Price list shall be considered for returns and credits. All products qualifying for return are subject to review for marketability (quantities and stock movement) before issuance of an RMA number.

All merchandise returned for credit must have been purchased from George Fischer within the past twelve (12) months, and must be in original packaging (full carton quantities), in "like new," re-sellable, condition.

Credit will be allowed at the lowest price in effect during the previous twelve (12) months, unless a higher price can be substantiated by the distributor. The minimum acceptable return is \$100 net. **No deductions may be taken prior to GFI issuing a credit memo.**

All material returns must be accompanied by a valid GFI Return

Material Authorization (RMA) number. Obtain the RMA number by contacting the GFI Customer Service department. When requesting restock, the original purchase order number or GFI Sales Order number and date of purchase from GFI must be provided. When requesting an RMA for material evaluation, the customer must first complete a Material Safety Disclosure sheet and Request For Evaluation form; both are obtained from GFI Customer Service.

Material arriving at George Fischer without a valid RMA number will be returned to the customer/distributor, freight collect. RMA numbers must be clearly referenced on all shipping documents and shipping container.

All material returns must be received within thirty (30) days of the RMA issuance from GFI. **RMA numbers are void after 30 days.**

All material returns must be shipped freight prepaid. **No collect shipments will be accepted by George Fischer.** Restocking charges and prepaid freight do not apply to warranty defective merchandise or returns due to GFI order entry or shipping errors. **Seller must be advised of shipment errors within 15 days of shipping from GFI.**

• Force Majeure

Seller shall not be liable for any delays in making delivery where occasioned by strikes or difference with workmen or by any causes beyond the control of Seller, such as but not limited to fires, floods, accidents, action of any governmental authority, or shortages of labor, energy, raw materials, production facilities or transportation. Where delays or failures of delivery are caused by labor difficulties, Seller shall not be obligated to seek or obtain any settlement which, in Seller's sole judgment is not in Seller's best interest.

• WARRANTY

Seller's Products are carefully inspected for manufacturing defects; however, it is not always possible to detect hidden defects.

Said Products are warranted only to the extent that Seller will repair or replace without charge. (No credits will be issued.) Products proved to have manufacturing defects within six (6) months, Signet products twenty-four (24) months, of the date of tender of delivery thereof and provided Seller has been given an opportunity to inspect the Product alleged to be defective and the installation and/or use thereof. Seller does not warrant any Products obtained through an unauthorized Distributor, Dealer or Agent; therefore any and all warranties are void in the event that Seller's Products are obtained through an unauthorized Distributor, Dealer or Agent.

• LIMITATIONS OF REMEDY

Damages, warranties and liability in the event of any breach of warranty by seller, the exclusive remedy of the customer shall be the repair or replacement of the non-conforming goods in the manner and for the period of time as provided in the "warranty" section above. No warranty is included against any expense for removal, reinstallation or consequential damages of any nature arising from any defect. Seller shall not be liable for special, incidental or consequential damages, such as (but not limited to) damage or loss of other property or equipment, business interruption, or loss of profits or revenue. The warranties set out above are the only warranties made by seller and are expressly in lieu of all other warranties, expressed or implied, including the warranties of merchantability and fitness for a particular purpose. Any and all warranties implied by any course of dealing or usage of trade between the parties are expressly excluded. Any action for breach of any contract made by seller for the sale of goods must be commenced within twelve (12) months (Signet Products twenty-four (24) months) of seller's tender of delivery of the subject goods.