



## **PPro-Seal™**

Natural Polypropylene  
Piping System

**Price List Effective  
May 1, 2005**

→Pipe, Valves, Fittings  
→Electrofusion  
→Mechanical Joint



# George Fischer Sloane, Inc.

Our modern facility in Little Rock, Arkansas, is the manufacturing center of George Fischer in the Americas. With state-of-the-art molding and extrusion machines, as well as engineering and customer service, we provide the industrial piping system user with a diverse range of products and technical support.

George Fischer products can be found in a broad spectrum of industries, such as chemical processing, semiconductor, pharmaceutical, food, photographic, environmental technology, marine, metal finishing, water and waste water.



Through strategically placed regional warehouses, a well-trained technical sales force, and a network of stocking distributors, George Fischer Sloane provides viable solutions.

## George Fischer, Inc. Tustin, California



George Fischer, Inc. is the sales facility of George Fischer high purity and industrial products in the Americas. The Tustin location offers customer and technical support, performs valve assembly, heat exchanger fabrication and distribution of George Fischer valves and piping systems. A Class 10,000 clean room offers custom fabrication of specialty components for the ultrapure water market.

## George Fischer Signet, Inc. El Monte, California



George Fischer Signet is the engineering, manufacturing, and distribution facility for Signet instrumentation.

# Table of Contents

Pipe .....	4
Electrofusion Fittings .....	5
Valves .....	8
Fusion Accessories.....	9
Threaded Fittings .....	10
Submittals .....	12
General Terms and Conditions of Sale .....	15
Warranty .....	15

The technical information given in this publication implies no warranty of any kind and is subject to change without notice. Please consult our Terms and Conditions of Sale.

Custom fittings available through custom products in Little Rock. Please contact your local George Fischer Sloane representative for prices and delivery.

## Glossary

- S = Electrofusion Socket
- SPG = Spigot End (same dimension as pipe outside diameter)
- MPT = Male Pipe Thread
- FPT = Female Pipe Thread

## Not for Use with Compressed Air or Gases

### Do Not Test with Air or Air Over Water

George Fischer Sloane, Inc. DOES NOT RECOMMEND the use of thermoplastic piping products for systems to transport or store compressed air or gases, or the testing of thermoplastic piping systems with compressed air or gases in above or below ground locations. The use of George Fischer Sloane, Inc. products in compressed air or gas systems automatically voids the warranty for such products, and their use against our recommendation is entirely the responsibility and liability of the installer. George Fischer Sloane, Inc. will not accept responsibility for damage or impairment from its products, or other consequential or incidental damages caused by misapplication, incorrect assembly, and/or exposure to harmful substances or conditions.



# PPro-Seal Electrofusion Fittings

P/L 36: PPro-Seal Electrofusion Fittings

Material: Natural Polypropylene

**Note:** All fittings must be ordered in standard pack quantities to maintain cleanliness.

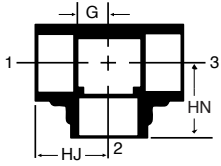

## Tee (SxSxS)

Inch Size	Part Number	List \$/ea.	std. pack	HJ	HN	G
1/2	801-005F	12.07	5	1.22	1.22	0.51
3/4	801-007F	14.37	5	1.36	1.36	0.58
1	801-010F	16.87	5	1.67	1.67	0.70
1 1/2	801-015F	25.24	2	2.03	2.03	1.00
2	801-020F	33.63	2	2.32	2.32	1.26
3	801-030F	100.00	1	3.72	3.72	1.87

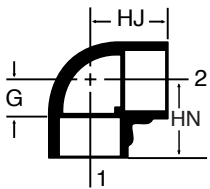

## 90° Ell (SxS)

Inch Size	Part Number	List \$/ea.	std. pack	HJ	HN	G
1/2	806-005F	10.14	5	1.22	1.22	0.51
3/4	806-007F	12.81	5	1.36	1.36	0.58
1	806-010F	16.06	5	1.67	1.67	0.70
1 1/2	806-015F	21.69	2	2.03	2.03	1.00
2	806-020F	29.23	2	2.32	2.32	1.26
3	806-030F	62.11	1	3.72	3.72	1.87

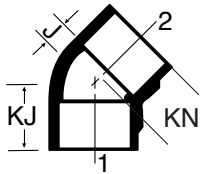

## 45° Ell (SxS)

Inch Size	Part Number	List \$/ea.	std. pack	KJ	KN	J
1/2	817-005F	14.00	5	1.02	1.02	0.31
3/4	817-007F	15.00	5	1.11	1.11	0.33
1	817-010F	18.00	5	1.36	1.36	0.39
1 1/2	817-015F	30.00	2	1.55	1.55	0.52
2	817-020F	40.00	2	1.70	1.70	0.64
3	817-030F	95.00	1	2.66	2.66	0.81

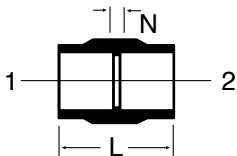

## Coupling (S x S)

Inch Size	Part Number	List \$/ea.	Std. Pack	L	N
1/2	829-005F	9.18	5	1.56	0.12
3/4	829-007F	11.26	5	1.68	0.12
1	829-010F	12.66	5	2.06	0.12
1 1/2	829-015F	16.87	2	2.25	0.18
2	829-020F	22.06	2	2.26	0.13
3	829-030F	40.00	1	4.00	0.31

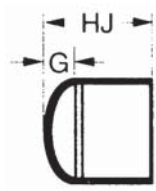

### Cap (S)

Inch Size	Part Number	List \$/ea.	Std. Pack	HJ	G
1/2	847-005F	12.00	5	1.14	0.42
3/4	847-007F	22.00	5	1.23	0.45
1	847-010F	25.00	5	1.50	0.53
1 1/2	847-015F	30.00	2	1.71	0.63
2	847-020F	40.00	2	1.84	0.75
3	847-030F	85.00	1	2.38	1.00

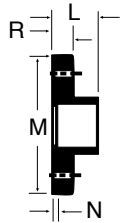

### Flange (S) Without Backing Ring

Inch Size	Part Number	List \$/ea.	Std. Pack	# hole	bolt dia.	bolt cir. dia.	L	M	N	R
1/2	859-005F	25.00	1	4	0.50	2.38	0.86	3.50	0.14	0.41
3/4	859-007F	30.00	1	4	0.50	2.75	0.97	3.88	0.19	0.47
1	859-010F	35.00	1	4	0.50	3.13	1.16	4.25	0.19	0.53
1 1/2	859-015F	40.00	1	4	0.50	3.88	1.24	5.00	0.21	0.66
2	859-020F	45.00	1	4	0.63	4.75	1.34	6.00	0.28	0.71
3	854-030F*	65.00	1	4	0.63	6.00	2.33	7.50	0.48	1.00

\* Van Stone Style

**Note:** Flange Backing Ring recommended for assembly.



### Flange Backing Ring (PVC Coated Metal)

Inch Size	Part Number	List \$/ea.	Std. Pack
1/2	855-005F	45.00	1
3/4	855-007F	50.00	1
1	855-010F	55.00	1
1 1/2	855-015F	60.00	1
2	855-020F	75.00	1
3	855-030F	105.00	1

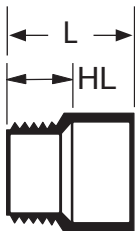

### Male Adapter (MPT x S)

Inch Size	Part Number	List \$/ea.	Std. Pack	L	HL
1/2	836-005F	12.00	5	1.73	1.02
3/4	836-007F	15.00	5	1.83	1.05
1	836-010F	17.00	5	2.25	1.28
1 1/2	836-015F	21.00	2	2.35	1.32
2	836-020F	33.00	2	2.43	1.37
3	836-030F	66.00	1	3.93	2.08

**Note:** Threaded Fitting Not Recommended for Pressure Applications.

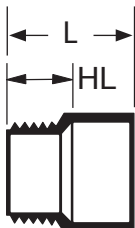

### Male Reducing Adapter (MPT x S)

Inch Size	Part Number	List \$/ea.	Std. Pack	L	HL
1/2 x 3/4	836-036F	13.50	5	2.00	0.79

**Note:** Threaded fitting not recommended for pressure applications.

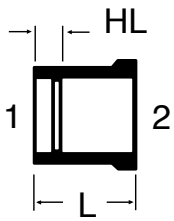

### Reducer Bushing (SPG x S)

Inch Size	Part Number	List \$/ea.	Std. Pack	L	HL
3/4 x 1/2	837-101F	13.50	5	1.86	1.14
1 x 1/2	837-130F	20.00	5	1.75	1.03
1 x 3/4	837-131F	20.00	5	1.88	1.10
1 1/2 x 3/4	837-210F	25.00	2	1.67	0.95
1 1/2 x 1	837-211F	25.00	2	2.00	1.03
2 x 1	837-249F	32.00	2	2.00	1.03
2 x 1 1/2	837-251F	32.00	2	1.84	0.81
3 x 1 1/2	837-337F	45.00	1	2.40	0.91
3 x 2	837-338F	45.00	1	2.40	0.88

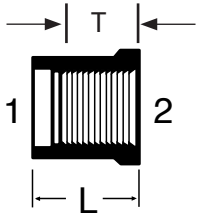

### Reducer Bushing (SPG x FPT)

Inch Size	Part Number	List \$/ea.	Std. Pack	L	T min.
3/4 x 1/2	838-101F	13.50	5	1.03	0.69
1 x 1/2	838-130F	20.00	5	1.25	0.69
1 x 3/4	838-131F	20.00	5	1.25	0.69
1 1/2 x 3/4	838-210F	25.00	2	1.28	0.69
1 1/2 x 1	838-211F	25.00	2	1.28	0.81
2 x 1	838-249F	32.00	2	1.31	0.81
2 x 1 1/2	838-251F	32.00	2	1.31	0.88
3 x 1 1/2	838-337F	45.00	1	2.10	0.88
3 x 2	838-338F	45.00	1	2.10	0.94

**Note:** Threaded Fittings Not Recommended for Pressure Applications.

# PPro-Seal Valves

P/L 10: PPro-Seal Valves

Material: Natural Polyprpylene

**Note:** All valves must be ordered in standard pack quantities to maintain cleanliness.

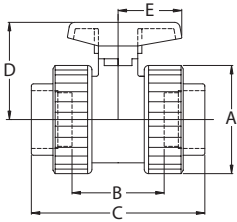

## Type 375 Ball Valve (S x S) and (FPT x FPT)

Inch Size	Part Number	List \$/ea.	Std. Pack	A	B	C	D	E
1/2	1088375005F	60.00	1	1.88	1.84	3.86	2.31	1.44
3/4	1088375007F	75.00	1	2.27	2.08	4.37	2.50	1.44
1	1088375015F	95.00	1	2.63	2.34	4.86	3.05	1.85
1 1/2	1088375015F	150.00	1	3.67	3.13	5.87	3.60	2.41
2	1088375020F	180.00	1	4.48	3.68	6.73	3.95	2.41
3	1088375030F	450.00	1	6.51	5.67	9.60	5.28	3.07

**Note:** O-Ring material: FPM.

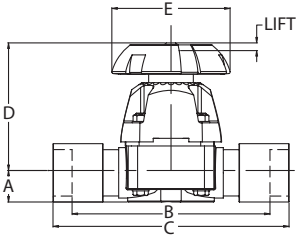

## Type 315 Diaphragm Valve (S x S)

Inch Size	Part Number	List \$/ea.	Std. Pack	A	B	C	D	E	Lift
1/2	1088315005F	275.00	1	0.55	5.12	6.54	3.54	3.15	0.31
3/4	1088315007F	300.00	1	0.69	5.82	7.50	4.02	3.15	0.43
1	1088315010F	350.00	1	0.83	6.06	8.00	4.67	3.70	0.51
1 1/2	1088315015F	425.00	1	1.28	8.27	10.33	5.47	4.61	0.83
2	1088315020F	500.00	1	1.53	9.10	11.22	6.77	5.98	1.10

**Note:** Diaphragm and backing material: EPDM

# PPro-Seal Fusion Accessories

P/L 07 Fusion Accessories

Standard Pack Quantities; No Broken Packs



## MSA Fusion Unit

[Includes (5) Cable Assy, Bar Code Set with Tester and Metal Case]

	Part Number	List \$/ea.	Std. Pack
110v	MSA250-SE	4,722.22	1
220v	MSA250-EX	4,722.22	1

## MSA Accessories

	Part Number	List \$/ea.	Std. Pack
Bar Code Set	MSABAR	33.33	1
Continuity Tester	TA1000	23.33	1

## MSA Fusion Cable

	Part Number	List \$/ea.	Std. Pack
Single Cable	MSA001	33.33	1
(5) Cable Assy	MSA001A	166.67	1

## MSA Carrying Case

	Part Number	List \$/ea.	Std. Pack
Metal Case	MSA2000	277.78	1



## Loose Coil

Inch Size	Part Number	List \$/ea.	Std. Pack
1/2	6076	3.67	10
3/4	6077	3.77	10
1	6078	3.91	10
1 1/2	6086	3.99	10
2	6089	4.31	10
3	6091	4.83	10

# PPro-Seal Threaded Fittings

P/L 09: PPro-Seal Schedule 80 Threaded Fittings

Material: Natural Polypropylene

**Note:** Threaded fittings are not recommended for pressure applications.

**Note:** All fittings must be ordered in standard pack quantities to maintain cleanliness.

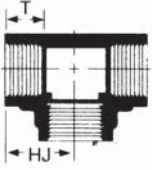

## Tee (FPT x FPT x FPT)

Inch Size	Part Number	List \$/ea.	Std. Pack	HJ	T min.
1/2	805-005F	8.77	5	1.22	0.69
3/4	805-007F	9.79	5	1.36	0.69
1	805-010F	13.00	5	1.67	0.81
1 1/2	805-015F	20.00	2	2.03	0.88
2	805-020F	24.00	2	2.32	0.94

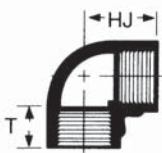

## 90° Ell (FPT x FPT)

Inch Size	Part Number	List \$/ea.	Std. Pack	HJ	T min.
1/2	808-005F	7.13	5	1.22	0.69
3/4	808-007F	8.67	5	1.36	0.69
1	808-010F	10.68	5	1.67	0.81
1 1/2	808-015F	14.47	2	2.03	0.88
2	808-020F	19.65	2	2.32	0.94

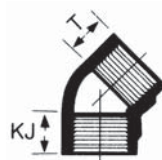

## 45° Ell (FPT x FPT)

Inch Size	Part Number	List \$/ea.	Std. Pack	KJ	T min.
1/2	819-005F	14.00	5	1.02	0.69
3/4	819-007F	15.00	5	1.11	0.69
1	819-010F	18.00	5	1.36	0.81
1 1/2	819-015F	30.00	2	1.55	0.88
2	819-020F	40.00	2	1.70	0.94

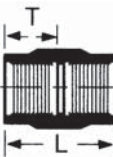

## Coupling (FPT x FPT)

Inch Size	Part Number	List \$/ea.	Std. Pack	L	T min.
1/2	830-005F	6.43	5	1.56	0.69
3/4	830-007F	8.44	5	1.68	0.69
1	830-010F	9.28	5	2.06	0.81
1 1/2	830-015F	12.19	2	2.25	0.88
2	830-020F	14.61	2	2.26	0.94

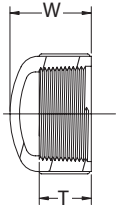

### Cap (FPT)

Inch Size	Part Number	List \$/ea.	Std. Pack	W	T min.
1/2	848-005F	12.00	5	1.14	0.69
3/4	848-007F	22.00	5	1.23	0.69
1	848-010F	25.00	5	1.50	0.81
1 1/2	848-015F	30.00	2	1.71	0.88
2	848-020F	40.00	2	1.84	0.94

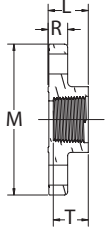

### Flange (FPT) Without Backing Ring

Inch Size	Part Number	List \$/ea.	Std. Pack	# hole	bolt dia.	bolt cir. dia.	L	M	R	T min.
1/2	852-005F	25.00	1	4	0.50	2.38	0.86	3.50	0.41	0.69
3/4	852-007F	30.00	1	4	0.50	2.75	0.97	3.88	0.47	0.69
1	852-010F	35.00	1	4	0.50	3.13	1.16	4.25	0.53	0.81
1 1/2	852-015F	40.00	1	4	0.50	3.88	1.24	5.00	0.66	0.88
2	852-020F	45.00	1	4	0.63	4.75	1.34	6.00	0.71	0.94



### Flange Backing Ring (PVC Coated Metal)

Inch Size	Part Number	List \$/ea.	Std. Pack
1/2	855-005F	45.00	1
3/4	855-007F	50.00	1
1	855-010F	55.00	1
1 1/2	855-015F	60.00	1
2	855-020F	75.00	1

**Note:** Flange Backing Ring recommended for assembly.

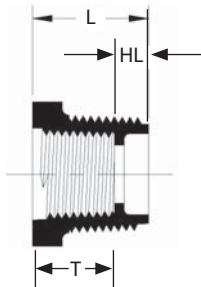

### Reducer Bushing (MPT x FPT)

Inch Size	Part Number	List \$/ea.	Std. Pack	L	HL max.	T min.
3/4 x 1/2	839-101F	13.50	5	1.70	0.95	0.69
1 x 1/2	839-130F	20.00	5	1.77	1.02	0.69
1 x 3/4	839-131F	20.00	5	1.89	1.10	0.69
1 1/2 x 1	839-211F	25.00	2	2.00	1.02	0.81
2 x 1	839-249F	32.00	2	2.00	1.02	0.81
2 x 1 1/2	839-251F	32.00	2	1.81	0.78	0.88

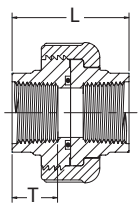

### Union (FPT x FPT)

Inch Size	Part Number	List \$/ea.	Std. Pack	L	T min.
1/2	898-005F	30.85	5	2.00	0.69
3/4	898-007F	33.97	5	2.08	0.69
1	898-010F	41.53	5	2.50	0.81
1 1/2	898-015F	62.97	2	2.69	0.88
2	898-020F	91.93	2	2.88	0.94

**Note:** O-Ring material: FPM

# George Fischer Piping Systems

## Natural Polypropylene Piping System Specification Submittal Data Sheet PPro-Seal Natural Polypropylene Pipe and Fittings

### Pipe

Pipe will be manufactured to the dimensions and tolerances of ASTM D1785. The material will be from natural virgin copolymer polypropylene with no added plasticizers, pigments or re-grind that is compliant with US Food and Drug Administration regulations 21.CFR 177.1520 Sections A1, B & C and conforms to ASTM D4101. All pipes shall be packaged in polybags at the point of manufacturing to preserve pipe cleanliness.

- PPn Sch.80 Group II Pipe - 10 ft. Lengths

### Fittings

Fittings will be manufactured to the dimensions and tolerances of George Fischer Sloane, Inc. The material will be from natural virgin copolymer polypropylene with no added plasticizers, pigments or re-grind that is compliant with US Food and Drug Administration regulations 21.CFR 177.1520 Sections A1, B & C and conforms to ASTM D4101. All fittings shall be packaged in polybags at the point of manufacturing to preserve fitting cleanliness.

- PPn Sch.80 Molded - Electrofusion
- PPn Sch.80 Molded - Threaded

### Joining

Pipe and fittings are joined by either electrofusion or threaded connections. Electrofusion joints will conform to ASTM F1290 and consist of a polypropylene jacked wire. Threaded joints will conform to NPT dimensions & tolerances. (Note: Threaded fittings are not recommended for pressure systems).

- Electrofusion
- Threaded

**Job Name:** \_\_\_\_\_

**Job Location:** \_\_\_\_\_

**Engineer:** \_\_\_\_\_

**Contractor:** \_\_\_\_\_

**Representative:** \_\_\_\_\_

# George Fischer Piping Systems

## Natural Polypropylene Piping System Specification Submittal Data Sheet

### PPro-Seal Natural Polypropylene True Union Ball Valve Type 375

#### Ball Valve

Ball valves shall be of True Union design with two-way blocking capability. Valves shall have a blow out proof stem with double stem seals. All O-rings shall be FPM and the valve seats shall be PTFE with an elastomeric backing of the same material as the valve seals. The valve shall be of floating ball design with full Schedule 80 bore. All ball valves shall have an adjustable seat carrier that can be adjusted or removed using the valve handle as a spanner wrench. The material will be natural virgin copolymer polypropylene with no added plasticizers, pigments or re-grind that meets the requirements of ASTM D4101 and is compliant with FDA 21.CFR 177.1520 Sections A1, B & C. The valve Type 375 shall have a pressure rating up to 150 psi at 68°F. All valves shall be packaged in containers at the point of manufacturing to preserve cleanliness.

PPN True Union BALL Valve Type 375

#### Joining

Valves are joined to pipe and fittings by either electrofusion or threaded connections. Electrofusion joints will conform to ASTM F1290 and consist of a polypropylene jacketed wire. Threaded joints will conform to NPT dimensions & tolerances. (Note: Threaded fittings are not recommended for pressure systems).

Electrofusion

Threaded

Job Name: \_\_\_\_\_

Job Location: \_\_\_\_\_

Engineer: \_\_\_\_\_

Contractor: \_\_\_\_\_

Representative: \_\_\_\_\_

# George Fischer Piping Systems

## Natural Polypropylene Piping System Specification Submittal Data Sheet

### PPro-Seal Natural Polypropylene Diaphragm Valve Type 315

#### Diaphragm Valve

Diaphragm valves upper body will be of glass-filled polypropylene material connected to lower body with exposed stainless steel bolts. All interior metal parts are to be sealed from outside influence. A position indicator must be present to determine diaphragm position. Diaphragms to be from EPDM material with EPDM elastomer backing. Metal threaded bushings shall be molded into lower body to facilitate mounting. Diaphragm valves lower body material will be natural virgin polypropylene with no added plasticizers, pigments or re-grind that meets the requirements of ASTM D4101 as pertains to type I homopolymer compound having a minimum tensile strength of 4350 psi at 73°F when tested in accordance with ASTM D-638 and shall have a melt point which initiates at 316°F. The melt flow index (at 374°F) shall be 0.4 - 0.8 grams per 10 minutes in accordance with ASTM D-1238. The valve Type 315 shall have a pressure rating up to 150 psi at 68°F. All valves shall be packaged in containers at the point of manufacturing to preserve cleanliness.

☐ PPN Diaphragm Valve Type 315

#### Joining

Valves are joined to pipe and fittings by electrofusion connections. Electrofusion joints will conform to ASTM F1290 and consist of a polypropylene jacked wire.

☐ Electrofusion

Job Name: \_\_\_\_\_

Job Location: \_\_\_\_\_

Engineer: \_\_\_\_\_

Contractor: \_\_\_\_\_

Representative: \_\_\_\_\_

# General Terms and Conditions of Sale

## George Fischer Sloane, Inc.

### Order Acceptance

George Fischer Sloane, Inc. (hereafter "Seller") reserves the right to accept or reject orders.

### Credit Approval

Seller must approve Customer's credit prior to sale. Seller may require payment in advance.

### Minimum Order

\$100 net.

### Freight

Normal domestic freight will be paid on pipe, valve, and fitting orders \$2,500 net or more. Fitting and valve orders will qualify for normal domestic freight allowed on orders of \$1,500 net or more. Freight allowed orders will be sent by a designated carrier/method of Seller's choice. Additional charges will be made for special handling, hotshot service, drop shipment, and air freight when requested.

### Taxes

Seller charges Customer for all sales, excise and other taxes and governmental charges Seller is required to collect from Customer. Customers claiming exemption must furnish documentation required by law which is satisfactory to Seller to permit Seller to refrain from collecting such charges.

### Broken Carton Charge

Seller may charge \$2 per each invoice line item reflecting sale of broken carton items.

### Changes in Prices or Terms

Seller's prices, discounts and terms are subject to change without notice. Any terms and conditions specified on Customer's purchase order, if any, or any other communication which are in conflict with, inconsistent with, or in addition to these terms and conditions, shall be superseded by these terms and conditions, and shall not be binding upon Seller unless expressly agreed to in writing by Seller. Seller's failure to object to terms in any written communication from Customer will not be a waiver of any of these terms and conditions.

### Terms

2% 15 Days, Net 30. This discount computed on invoice net of freight.

### Other Charges

Customer agrees to pay all expenses of collection (including reasonable attorneys' fees). Upon Customer's failure to make timely payment, Seller reserves the right to terminate this agreement or an order, or to suspend further deliveries, in addition to all other remedies available to Seller. A service charge of 1½% per month on any unpaid balance, or, where unlawful, at the highest rate permitted by law, will be levied on past due accounts.

### Special Packaging and Handling Charges

Seller packages and handles orders in the most economical manner. If Seller pays freight, Seller may hold shipment until all items become available. Customer bears extra cost of special packaging or handling requested by Customer.

### Order Changes or Cancellations

Seller begins processing orders on receipt. Seller may charge Customer for costs of canceling or changing an order, and Seller may treat order changes as a new order subject to charges and terms applicable to new orders hereunder. Seller will not cancel orders for non-standard or custom produced fittings, valves or pipe if Seller already has produced the items or incurred expenses toward producing them at the time Customer seeks to cancel.

### Delivery Dates/Disclaimer of Seller's Liability for Late Deliveries

Seller's delivery dates are estimates. Seller uses best efforts to meet such dates. HOWEVER, SELLER DISCLAIMS LIABILITY FOR CONSEQUENTIAL DAMAGES FROM LATE DELIVERIES UNLESS SELLER ASSUMES LIABILITY FOR SUCH DAMAGES IN WRITING WHEN ORDER IS PLACED. Further, Seller disclaims liability where delivery delays caused by strike, differences with workmen, or causes beyond Seller's control, including but not limited to fires, floods, accidents, government actions, shortages of labor, raw materials, production facilities, or transportation. Where delivery delays are caused by labor problems, Seller is not obligated to seek or obtain any settlement which, in Seller's judgment, is not in Seller's best interest.

### Damage or Loss in Transit

Seller ships FOB point of shipment via common carrier, and disclaims liability for damage or loss after goods are delivered to the carrier.

### Non-Conforming Shipments

Customer must notify Seller in writing within 7 days after receipt of shipments not conforming with Customer's order, stating specifically Customer's claim of non-conformity, or Customer is deemed to accept the shipment as is. If Seller is satisfied the shipment is non-conforming, Seller will (i) credit Customer for the price of defective goods or goods shipped but not ordered (including allocated outbound and return freight) upon return of the goods; (ii) promptly ship omitted items waiving Seller's new order charges.

### Return of Goods

George Fischer Sloane, Inc. does not accept material for return for credit or replacement unless it is for the following reasons:

- a) Product warranty issues
- b) GFS shipping or order entry errors

Return requests must be submitted in writing. Approved requests will be issued an RMA number which must accompany all return shipments. Requests for returns that do not meet our standard terms must be reviewed by the Vice President of Sales or the Customer Service Manager for consideration.

### Six Month Limited Warranty

Seller warrants to the project owner, contractor, or mechanic purchasing the goods herein that it will REPAIR OR REPLACE without charge products proved to have manufacturing defects within six (6) months of the date of delivery, and provided Seller, has been given an opportunity to inspect the product alleged to be defective and the installation or use thereof. No liability exists for improper use or installation of Seller's products. NO WARRANTY IS INCLUDED AGAINST ANY EXPENSE FOR REMOVAL, REINSTALLATION OR INCIDENTAL OR CONSEQUENTIAL DAMAGES ARISING FROM ANY DEFECT. THE ABOVE REMEDY IS EXCLUSIVE. THERE ARE NO OTHER WARRANTIES, EXPRESS OR IMPLIED, INCLUDING IMPLIED WARRANTIES OF MERCHANTABILITY OR FITNESS FOR A PARTICULAR PURPOSE. SELLER WILL NOT BE RESPONSIBLE FOR ANY DAMAGES OR OTHER CHARGES IN EXCESS OF THE PURCHASE PRICE PAID TO SELLER FOR THE PRODUCTS, WHETHER IN BREACH OF CONTRACT, WARRANTY OR TORT. Customer is responsible for compliance with all product warnings (including on Material Safety Data Sheets, if applicable) and instructions for use.

**Governing Law.** All orders shall be governed by Arkansas law, without regard to Arkansas conflict of laws rules. All claims or disputes between Customer and Seller shall be decided by the courts of the State of Arkansas.

# PPro-Seal™

## Natural Polypropylene Piping Systems



Certified QMS ISO 9001: 2000  
Certified EMS ISO 14001: 1996



AG